

motorsport rally range **KDC7804**

Ø200 (7.87") Rally driven plates

Driven Plates

Spline Size	Ø	No. of Teeth	Standard 15.0mm long hub	Alternative 12.0mm long hub	New Thickness
29 × 10T	29	10	KDC780410X001	-	7.6
25 × 14T	25	14	KDC780412X001	-	7.6
21 × 18T	21	18	KDC780417X005	-	7.6
0.875" × 20T	22.2	20	KDC780425X005	-	7.6
24.25 × 21T	24.25	21	KDC780427X004	-	7.6
29 × 21T	29	21	KDC780428X001	-	7.6
1.0" × 22T	25.4	22	KDC780429X002	-	7.6
1.0" × 23T	25.4	23	KDC780430X002	KDC780430X004	7.6
20.5 × 24T	20.5	24	KDC780432X002	-	7.6
24.25 × 24T	24.25	24	KDC780450X002	KDC780450X001	7.6
1.0" × 24T	25.4	24	KDC780433X001	-	7.6
25.8 × 24T	25.8	24	KDC780486X002	-	7.6
22 × 26T	22	26	KDC780435X002	-	7.6
22 × 28T	22	28	KDC780495X001	-	7.6

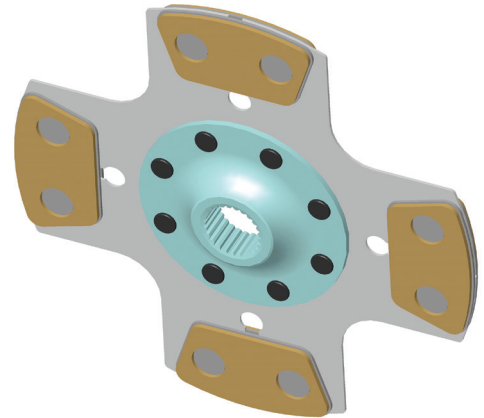

Applications

General Rally and Circuit use.

Key features and benefits

- Optimised design.
- Optimised hub length for low inertia with minimum hub wear.
- Cerametallic friction material for high energy capacity and increased wear rate.
- Interchangeable with other manufacturers' product.
- Various hub configurations available to provide increased hub to crank bolt clearance.
- 7.6mm plate thickness.

Installation dimensions

